

THE ASTLEY COOPER SCHOOL

New Building Plans



CGI of proposed main entrance

Welcome

New Building Plans

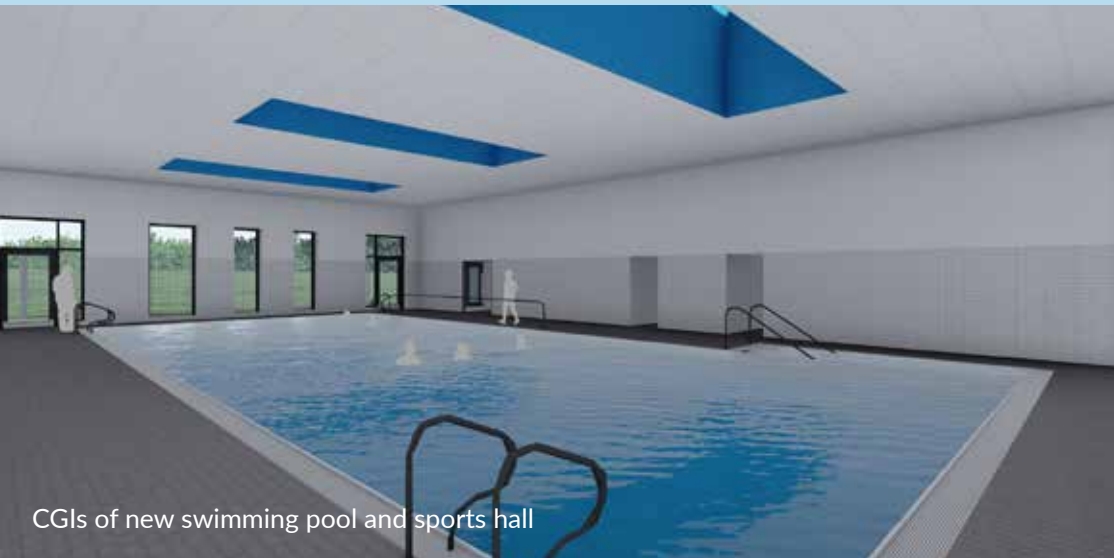

CGIs of new swimming pool and sports hall



Introduction

- Bowmer + Kirkland (B+K) has been selected by the Department for Education (DfE) as the main contractor to deliver new building plans.
- The Astley Cooper School is an 11-18 Co-operative Trust school on St Agnells Lane on the outskirts of Hemel Hempstead.
- This webinar introduces the proposals for two new buildings and improvements to the school layout as part of the Government's Priority School Building Programme.
- Before we submit our planning application to Dacorum Borough Council we are asking stakeholders and the community to review and comment on the plans.
- After this webinar please visit our website astleycooperplans.co.uk for more information, to watch our fly through and to share your feedback.
- Please share your comments by **Wednesday 10th March 2021**.

THE ASTLEY COOPER SCHOOL

New Building Plans

Webinar panelists



Main Contractor

Dylan O'Brien, Bowmer + Kirkland



The Astley Cooper School

Edward Gaynor, Headteacher



Planning Consultants

Bob Robinson, DPP



Architects

Hugh Avison, CPMG



Landscape Architects

Thea Roberts, Ares



Community Engagement

Rebecca Darling, Stonyrock

New Building Plans

Our Plans

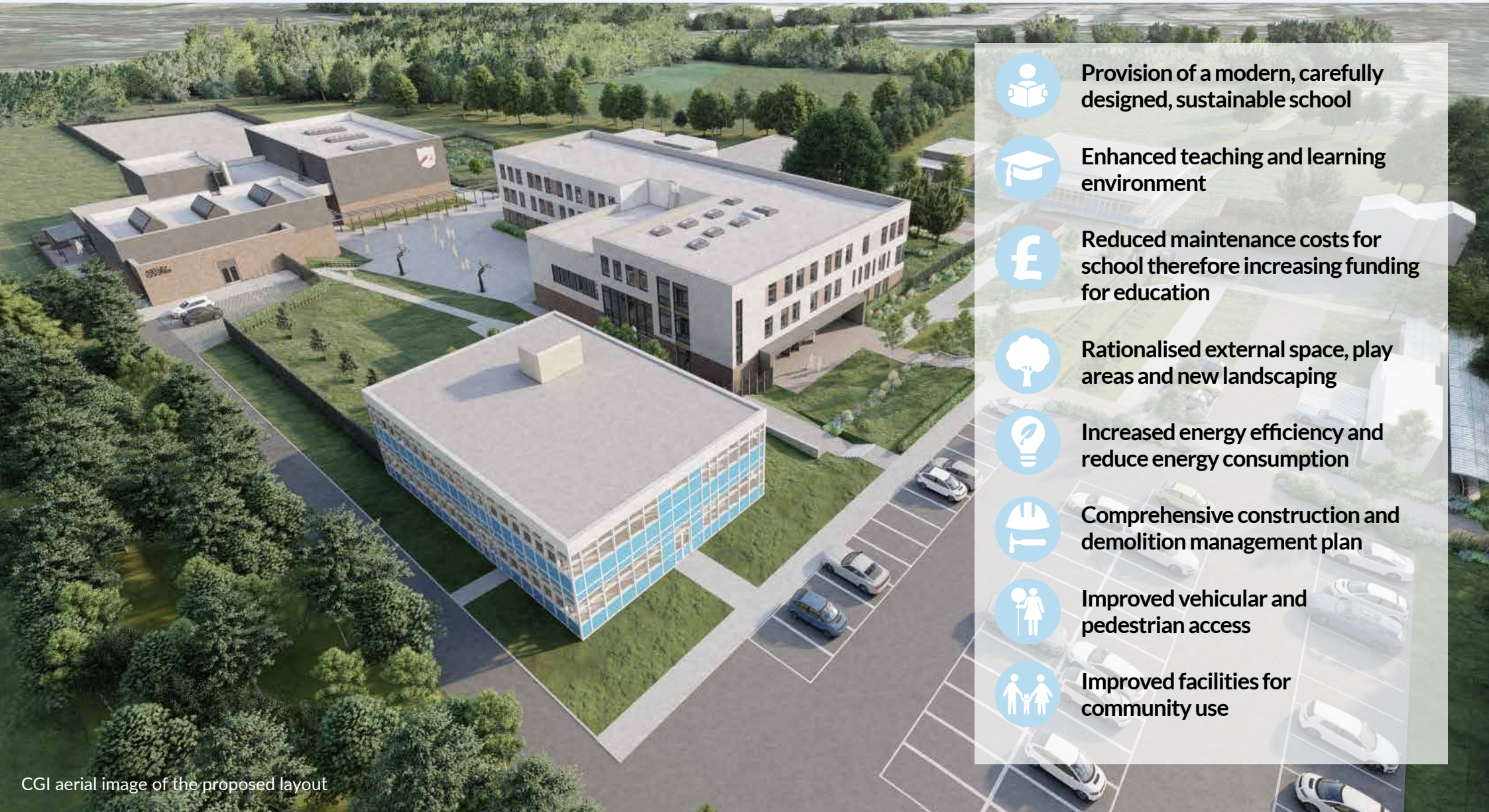

Provision of a modern, carefully designed, sustainable school



Enhanced teaching and learning environment



Reduced maintenance costs for school therefore increasing funding for education



Rationalised external space, play areas and new landscaping



Increased energy efficiency and reduce energy consumption



Comprehensive construction and demolition management plan



Improved vehicular and pedestrian access



Improved facilities for community use

New Building Plans

About The Astley Cooper School

At The Astley Cooper School, we strive for the very best for all our students. We are committed to ensuring that when students leave, they have become successful, well rounded and confident individuals prepared to succeed in the modern world.

Our core values of Aspiration, Determination and Integrity underpin our curriculum.

We achieve this by delivering the highest possible academic standards and offering students a wealth of opportunities within and beyond the national curriculum to develop their talents.



The prospect of a bright, modern, three-storey building fit for 21st century education is something to look forward to.

Edward Gaynor, Headteacher

THE ASTLEY COOPER SCHOOL

New Building Plans

Masterplan

The proposed layout has been carefully considered during the design process to take into account the characteristics of the site, the school's neighbours and the requirement for the school to remain operational during construction.



Proposed site plan



Existing site plan

New Building Plans

Design

Through a detailed and collaborative design process with the DfE and The Astley Cooper School our plans deliver an inspiring and sustainable place to learn and teach. The design includes;

- The construction of two new school buildings to meet the specific needs of Astley Cooper and enable every young person to achieve their full potential.
- The continued delivery of an excellent education during construction with an improved and robust pupil safeguarding strategy.
- The use of sustainable, low maintenance materials that complement the existing school buildings.
- The use of materials and technology to create an energy efficient, low acoustic environment that maximises natural light.
- The provision of enhanced community use facilities outside of school hours.
- The creation of a new face of the school, enhancing the visitor experience and championing a strong identity.
- Flexible internal and outdoor learning spaces in support of adaptable school management aligned with Covid-19 recovery.



New Building Plans

Internal Design



The new buildings internal layout has been designed to match the demands of the modern curriculum and will enable the school to make significant savings in running costs. It includes;

- Improved passive supervision and circulation with one way possibilities.
- A multi-functional heart space.
- Subject areas zoned according to departments – encouraging group work and use of live resources.
- Best practice learning environment and provision of modern robust classroom fittings and furniture environment.
- Zoning solutions to improve energy efficiency for rooms not in use and for out of hours usage.



CGIs of proposed internal spaces



THE ASTLEY COOPER SCHOOL

New Building Plans

Ground Floor Plan



THE ASTLEY COOPER SCHOOL

New Building Plans

First Floor Plan



THE ASTLEY COOPER SCHOOL

New Building Plans

Second Floor Plan



New Building Plans

Leisure Centre

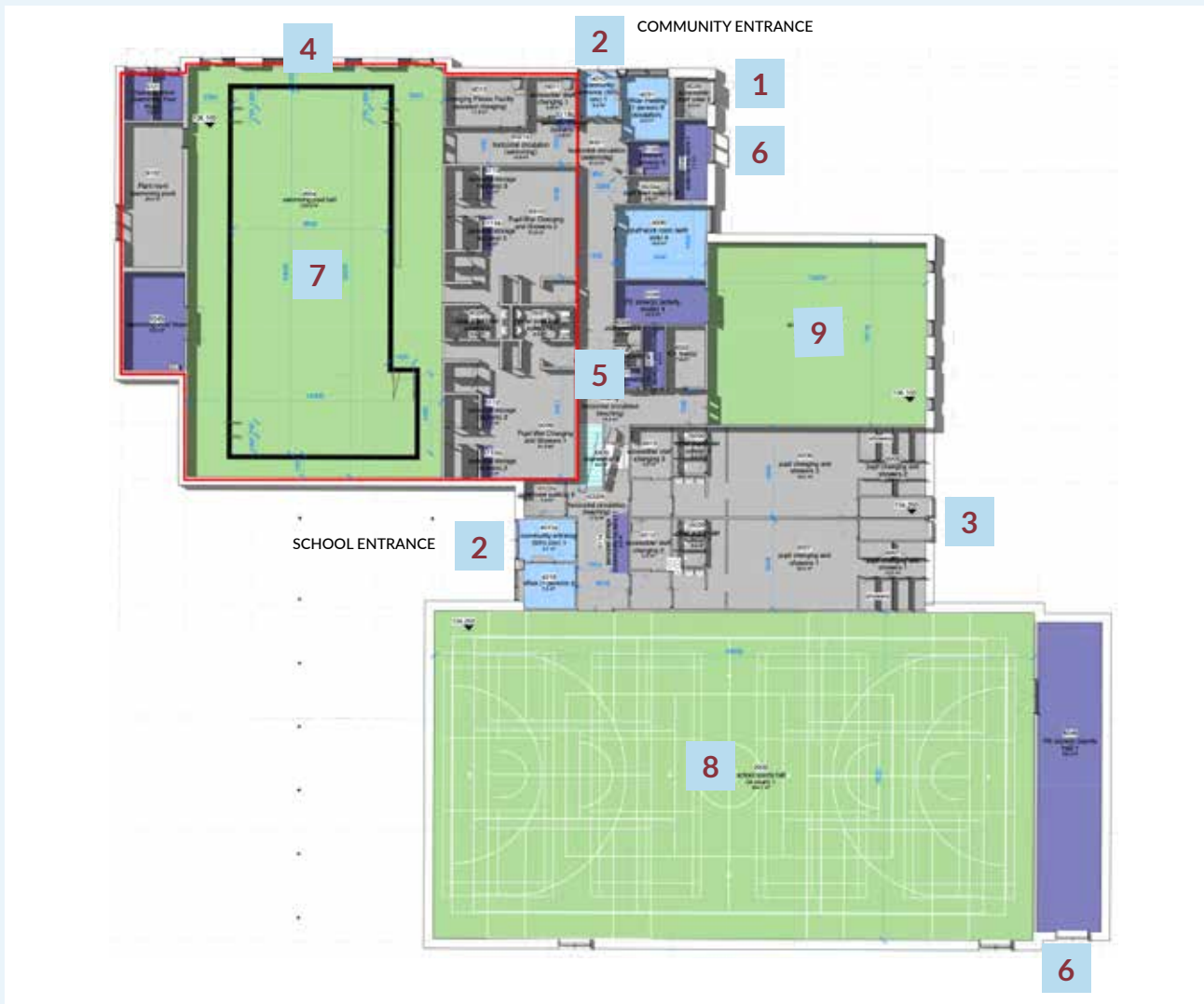

The plans include the creation of a new Leisure Centre providing improved community use.

- 1 Externally accessed WC for sports spectators
- 2 Separate student & community access to swimming pool
- 3 Direct access to sports fields from changing
- 4 Appropriate pool hall glazing
- 5 Community access to Activity Studio
- 6 Accessible external PE equipment stores
- 7 Swimming pool
- 8 Sports hall
- 9 Activity studio

THE ASTLEY COOPER SCHOOL

New Building Plans

Construction Information

- Bowmer + Kirkland (B+K) has extensive experience of managing sites where the school remains open.
- The complex programme of construction and demolition will carefully consider the local community and allow the school to continue to operate safely throughout the redevelopment programme.
- Traffic and construction management plans will be in place. Deliveries and vehicle movements will be programmed to minimise disruption to the neighbouring area.
- Pupil safety and the maintenance of high-quality education is paramount, our phased programme carefully considers the needs of the school (for example exam timetables and school holidays) and will adapt accordingly.
- Temporary buildings will be erected on the current hard play area for staff offices and canteen facilities only, vehicle access will be unaltered.
- B+K will continue to keep you informed after submission of this planning application and if approved throughout the construction process.

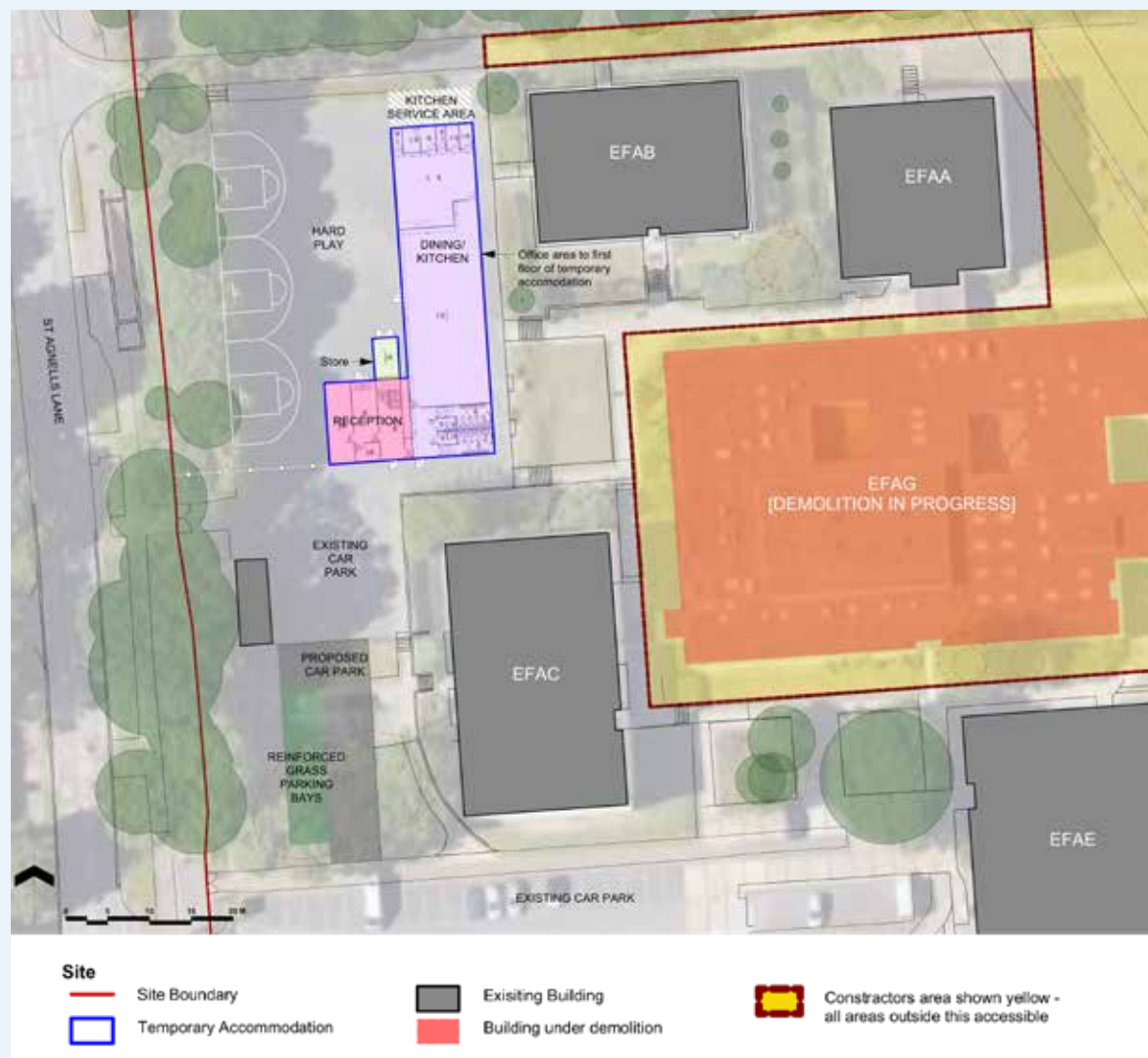

New Building Plans

Timeline

The Astley Cooper School apply for the Government's Priority School Building Programme and are successful in their bid

2020

Investigative works to determine scope of new building plans

2021

Main contractor allocated to undertake the redevelopment

Spring 2021

Submit planning application to Dacorum Borough Council

Autumn 2021

Construction work begins of phased redevelopment on site

Summer 2023

The Astley Cooper School redevelopment and landscaping complete

THE ASTLEY COOPER SCHOOL

New Building Plans

Next Steps and Q&A

The information shown here is available on the website astleycooperplans.co.uk where you can also watch a fly through film of the plans.

Once you have had the opportunity to review the plans please use the feedback form on our website to share your views **by Wednesday 10th March 2021.**

The project team will review your comments before submitting the planning application to Dacorum Borough Council.

Thank you for taking the time to join our webinar. We hope you have found it useful.



CGI of outdoor sports area



CGI of proposed main entrance

